

THREADED CONNECTIONS—BRASS FITTED

Max. working pressure 125 psig • Max. liquid temperature 180°F (continuous use), 211°F (intermittent use) • Rotation C.W. (motor end)

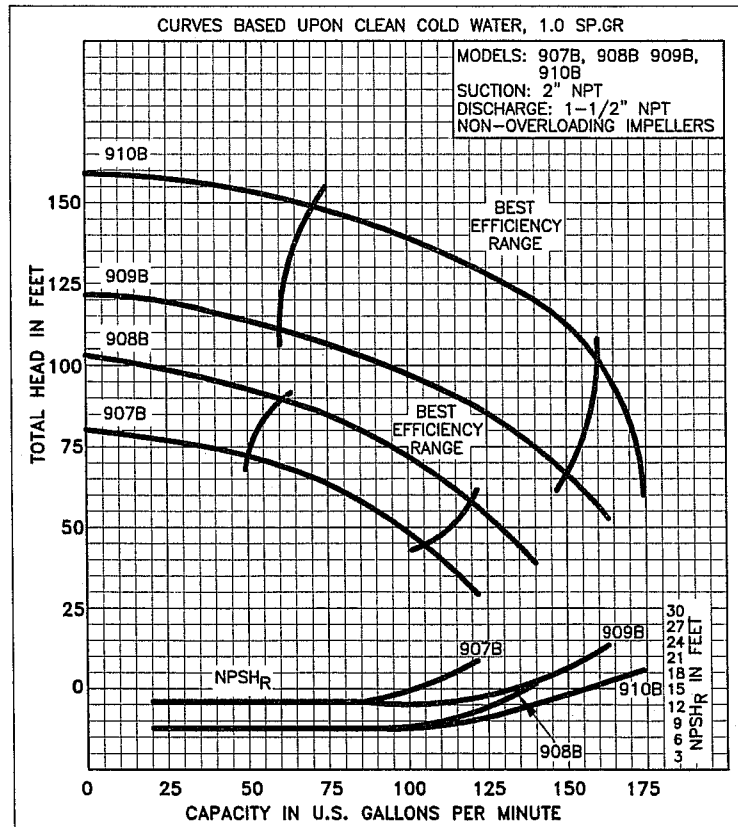
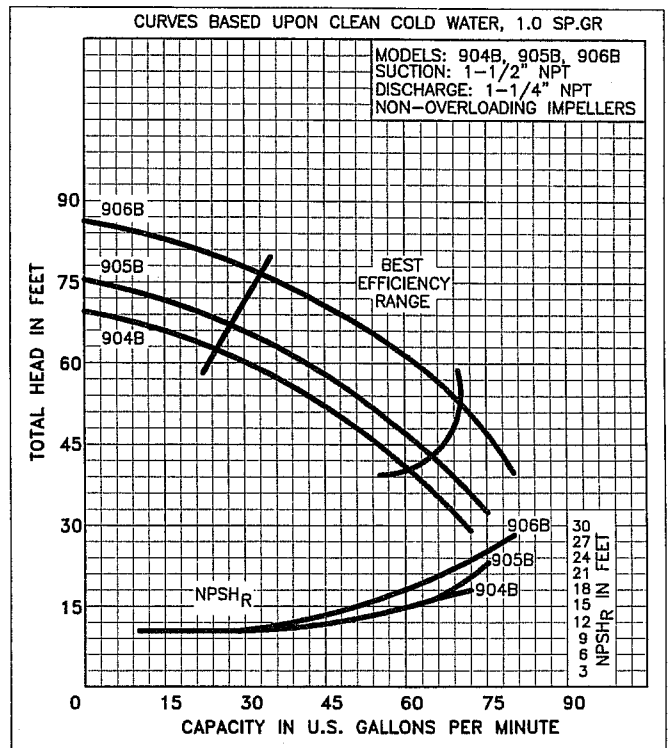
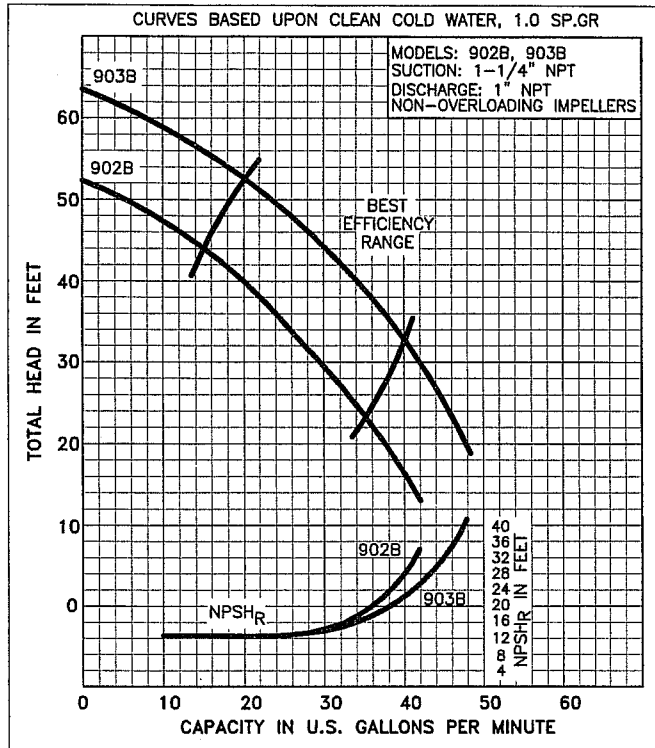

3450 RPM 60 HZ. ODP MOTORS					
MODEL	HP	SF	PH	VOLTAGE	FR.
3-902B-1	1/3	1.75	1	115	56C
3-902B-3	1/3	1.75	3	208-230/460	56C
3-903B-1	1/2	1.60	1	115/230	56C
3-903B-3	1/2	1.60	3	208-230/460	56C
3-904B-1	3/4	1.50	1	115/230	56C
3-904B-3	3/4	1.50	3	208-230/460	56C
3-905B-1	1	1.40	1	115/230	56C
3-905B-3	1	1.40	3	208-230/460	56C
3-906B-1	1-1/2	1.30	1	115/230	56C
3-906B-3	1-1/2	1.30	3	208-230/460	56C
3-907B-1	2	1.20	1	115/230	56C
3-907B-3	2	1.20	3	208-230/460	56C
3-908B-1	3	1.15	1	115/230	56C
3-908B-3	3	1.15	3	208-230/460	56C
3-909B-1	5	1.15	1	208-230	184TC
3-909B-3	5	1.15	3	208-230/460	182TC
3-910B-3	7-1/2	1.15	3	208-230/460	184TC

TEFC Motors Available - Consult Factory

PUMP COMPONENT	MATERIAL
Casing, motor bracket, and base plate	Cast iron
Impeller	Brass
Pump shaft (902B thru 906B)	Brass (AISI 416 S.S. optional)
Pump shaft (907B thru 910B)	AISI 416 S.S.
Shaft seal	Carbon/ceramic with Buna-N elastomer and stainless steel parts (Viton® elastomer optional)

Viton® is a registered trademark of DuPont



LANCASTER CENTRIFUGAL GENERAL SERVICE PUMPS

TYPE M 902B THRU 908B

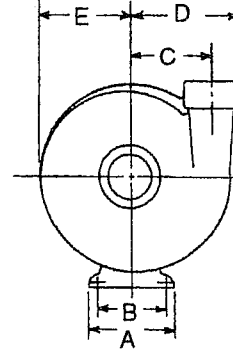
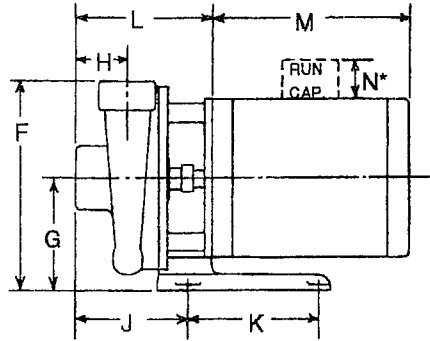

MODEL NO.	SUCTION	DISCHARGE
902B-903B	1-1/4" NPT	1" NPT
904B-906B	1-1/2" NPT	1-1/4" NPT
907B-908B	2" NPT	1-1/2" NPT

TYPE M 909B THRU 910B

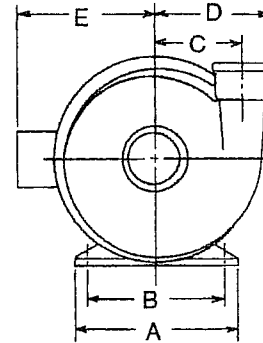
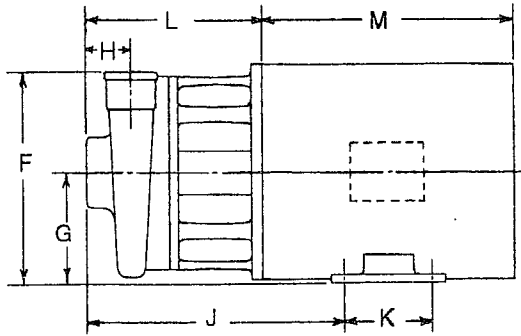

MODEL NO.	SUCTION	DISCHARGE
909B	2" NPT	1-1/2" NPT
910B	2" NPT	1-1/2" NPT

#	A	B	C	D	E	F	G	H	J	K	L	M	FR
902B	4-7/8	3-7/8	3-3/8	4-1/2	3-7/8	8-3/4	4-3/4	2-1/4	4-5/8	5-7/8	5-7/8	8-3/16	56C
903B	4-7/8	3-7/8	3-3/8	4-1/2	3-7/8	8-3/4	4-3/4	2-1/4	4-5/8	5-7/8	5-7/8	8-9/16	56C
904B	4-7/8	3-7/8	3-3/8	4-1/2	3-7/8	8-3/4	4-3/4	2-1/4	4-5/8	5-7/8	5-7/8	9-3/16	56C
905B	4-7/8	3-7/8	3-3/8	4-1/2	3-7/8	8-3/4	4-3/4	2-1/4	4-5/8	5-7/8	5-7/8	10	56C
906B	4-7/8	3-7/8	3-3/8	4-1/2	3-7/8	8-3/4	4-3/4	2-1/4	4-5/8	5-7/8	5-7/8	11	56C
907B	4-7/8	3-7/8	3-3/8	5-1/8	4-1/8	9	4-3/4	2-1/4	4-13/16	5-7/8	6-1/16	11	56C
908B	4-7/8	3-7/8	3-3/8	5-1/8	4-1/8	9	4-3/4	2-1/4	4-13/16	5-7/8	6-1/16	12	56C
909B	8-11/16	7-1/2	3-13/16	5-1/8	7	9-3/16	4-15/16	2-1/4	11-15/16	4-1/2	8-7/16	11.7	182TC
910B	8-11/16	7-1/2	3-13/16	5-1/8	7	9-3/16	4-15/16	2-1/4	11-15/16	5-1/2	8-7/16	12.7	184TC

General notes for estimating only. All dimensions in inches.
 Motor dimensions are General Electric and may vary with other brands.
 902 thru 908 .375 mounting holes in motor support foot.
 908 and 910 .406 mounting holes in motor base.
 *N--Single phase motors only 1.5 to 2.25 inches.

LANCASTER PUMP A DIVISION OF C-B TOOL CO.

1340 Manheim Pike • Lancaster, PA 17601-3196 • Phone 717-397-3521 • Fax 717-392-0266 • www.lancpump.com
 Printed in U.S.A. - Trademark Registered - Specifications subject to change without notice.